

# Euro Step Lite Solid Eyelid PURE LED

Cat. NO ESLS/L

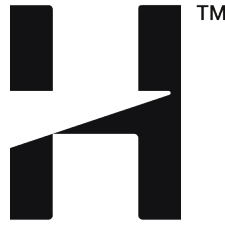
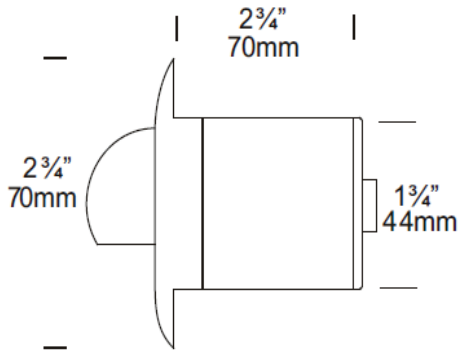

**PURE LED**  
Pure Performance

The Euro Step Lite Solid Eyelid PURE LED is an extra compact luminaire designed for step lighting applications where the fixture needs to be very unobtrusive or concealed. The eyelid masks two thirds of the lamp, which eliminates all upward light.

The Hunza PURE LED system uses the latest Cree MTG-2 LED chips for maximum performance and long life. Power supply options include a choice of integral 12 volt driver or an external remote driver. The PURE LED system incorporates an innovative Plug-and-Play system for easy replacement or upgrade of either the LED engine or integral driver.

\*At 350mA this fitting is the equivalent of a 25w halogen fitting.

\*At 700mA this fitting is the equivalent of a 35w halogen fitting.

## Ordering Information

Luminaire	Driver mA	Beam Angle	Colour Temp	Accessories	Material/Finish
ESLS/L	S - Series D3 - 12v 350mA D7 - 12v 700mA	15 - 15° TIR Lens 25 - 25° TIR Lens 38 - 38° TIR Lens	2 - 2700K 3 - 3000K 4 - 4000K	CJK150 - Cable Joint Kit EURF - Frosted Lens ELCAN - Euro Lite Canister	COP - Copper SS - Stainless

Ordering Example: EWS/L S 15 3 CJK150 SS

**HUNZA**™ PURE  
OUTDOOR  
LIGHTING

HUNZA FACTORY  
130 Felton Mathew Ave  
Saint Johns  
Auckland 1072  
New Zealand

Ph: 64-9-528 9471  
Fax: 64-9-528 9361  
hunza@hunza.co.nz  
www.hunza.co.nz

INTERNATIONAL CONTACTS:  
www.hunza.co.nz/contacts.php

Specifications may change without notice.  
Manufactured in New Zealand.  
© 2015 Hunza Holdings Ltd.

## Luminaire Construction

### CNC machined from:

#### Copper

Body: 45mm Copper (1 $\frac{3}{4}$ " ) rod.  
Flange: 70mm (3 $\frac{1}{2}$ " ) solid copper rod.

#### Stainless Steel

Body: 45mm (1 $\frac{3}{4}$ " ) 316 Stainless Steel rod.  
Flange: 70mm (3 $\frac{1}{2}$ " ) solid 316 Stainless Steel rod.

### Luminaire Weight

Cop .635kg (1lb 6oz)  
SS .585kg (1lb 4oz)

## Features

### Lens:

6mm (1/4") extra clear low iron flush fit shatter resistant glass with Hex Cell Louvre for glare control. Lifetime Warranty.

### Gasket:

Silicone, iron impregnated 220°c (428°f)

### Accessories:

Cable Joint Kit (Cat. CJK150)  
Euro Lite Canister (Cat. Elcan).  
Frosted Lens (Cat. EURF).

### Mounting

The Euro Step Lite is fixed in place using a mounting canister. There are no mounting screws in the flange to spoil aesthetics of the luminaire.

## Technical Information

### Standards

IP66 UL 1838

### LED

Cree MTG-2 Plug and Play, field replaceable PCB boards

**Lumen Output:** 420 at 700mA

**Lumens Per Watt:** 105 at 4 watts

**CRI Warm White (3000K):** 85+

**Colour Temp:** 2700K, 3000K and 4000K

### Power Supply

#### External (Series) Driver

Constant current driver

Output: 6vdc at 700mA maximum

#### Integral 12 Volt Driver

Hunza™ Plug and Play Driver

Input: 12vac, 5watt total

Output: 6vdc nominal, 350 / 700mA

#### Transformer

Hunza™ Wall Mount Transformer for use with integral 12v driver

## Reflector Beam Angles

